

# SMITH Style

**DELUXE**

**Radio DAB+/FM**

**Instruction Menu**

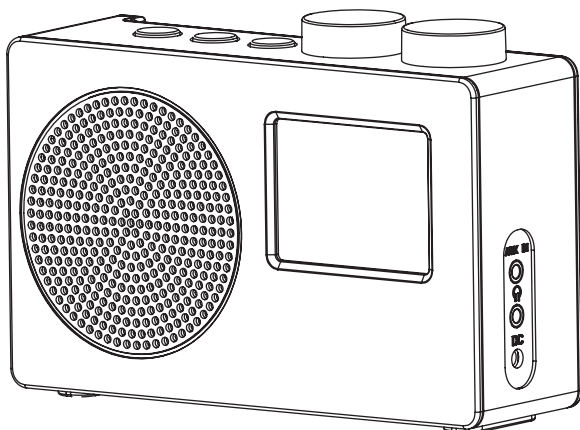

# Content

• Important safety information	P.3
• Your Digital Radio	P.3
• Packing List	P.3
• Switch on by Main	P.4
• Switch on by battery	P.4
• Mode change	P.4
• Volume Control	P.5
• Change Station (DAB)	P.5
• Change Station (FM)	P.5
• Menu	P.6
• Slide Show	P.6
• Timer	P.7
• Sleep	P.8
• Alarm	P.9
• Change Equalizer setting	P.10
• AUX In	P.10
• My EQ Setup	P.11
• Time / Date	P.12
• Backlight	P.13
• Language	P.14
• Factory Reset	P.14
• Store Stations	P.15
• Recall Store Stations	P.15
• Trouble Shooting	P.16
• Error Messages	P.16
• Specifications	P.16
• General Information	P.17
• Guarantee	P.17

Thank you for purchasing this DAB+/FM radio. Please read the instructions and warnings carefully before use, to ensure safe and satisfactory operation of this product.

## Important Safety Information

It is most important this instruction booklet be retained with the product for future reference. These warnings have been provided in the interest of safety. You **MUST** read them carefully before using the appliance.

- This appliance is not intended for use by persons (including children) with reduced physical, sensory or mental capabilities, or lack of experience and knowledge, unless they have been given supervision or instruction concerning use of the appliance by a person responsible for their safety.
  - To protect against fire, electric shock and injury to persons **DO NOT IMMERS**E CORD, plug or base unit in water or other liquids.
  - Unplug from the mains when not in use, before putting on or taking off parts and before cleaning.
  - Do not operate any appliance with a damaged cord or plug, or after the appliance malfunctions or has been damaged in any manner.
  - Do not let power cord hang over edge of table or counter, or touch hot surfaces.
  - In the event of a fault, do not attempt to repair by the consumer.
  - Do not use the appliance for anything other than intended use.
  - For household use only.
  - Do not use outdoors.
  - Save these instructions for future reference.
- WARNING! Polythene bags over the product or packaging may be dangerous.
- To avoid danger of suffocation, keep away from babies and children.
  - In general, battery chargers and power supplies should not be plugged in at night or when you are not home. All Smith-Style products are CE approved and certified.

## Your Digital radio

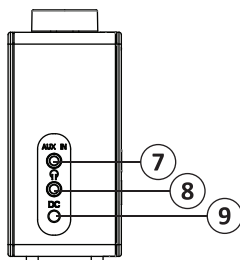
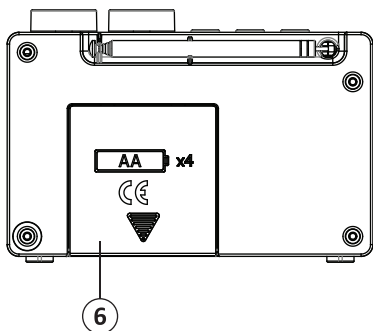
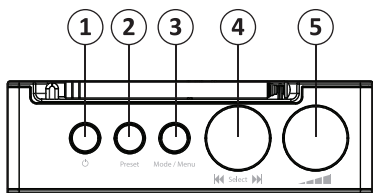

- 1 On/Off
- 2 Preset
- 3 Mode/Menu
- 4 Channel
- 5 Volume
- 6 Battery Compartment
- 7 AUX in
- 8 Earphone jack
- 9 DC in

## Packing List

1. Digital radio x 1
2. Power adapter x 1
3. Instruction manual x 1

# 1. Switch on by Main

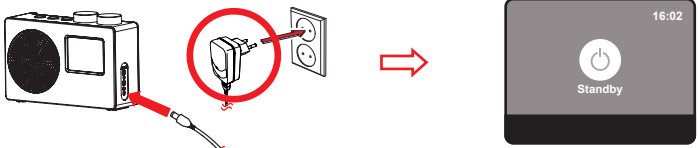

Note: Standby mode only available when radio powered by adapter.

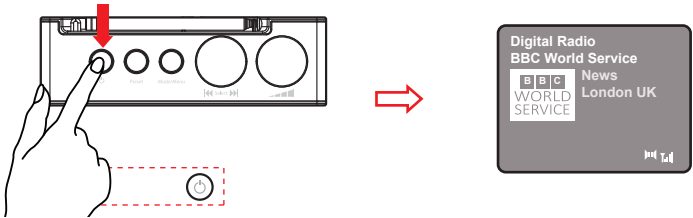

# 2. Switch on by battery

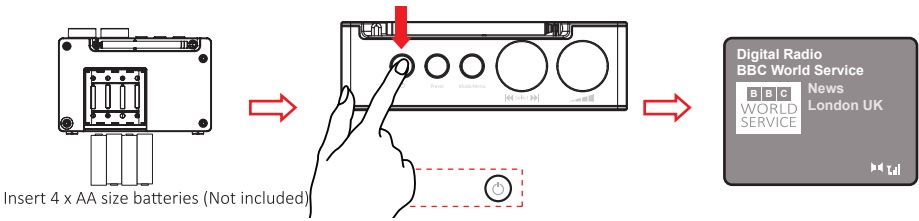

Insert 4 x AA size batteries (Not included)

# 3. Mode Change

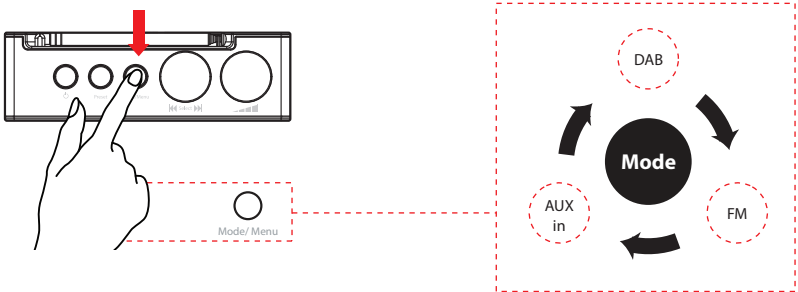



## 4. Volume Control

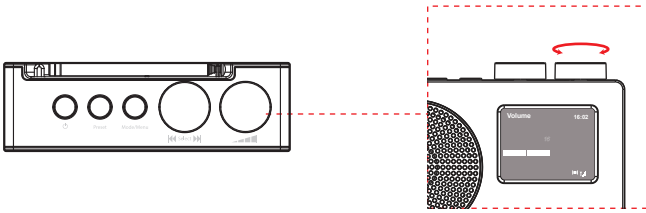

## 5. Change Station (DAB)

Select the station you wish to listen to and press select

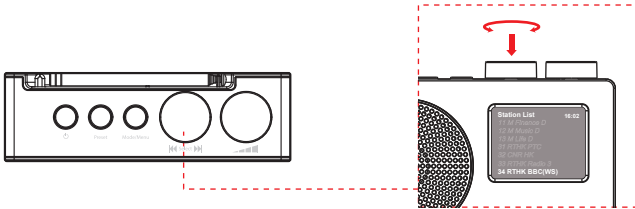

## 6. Change Station (FM)

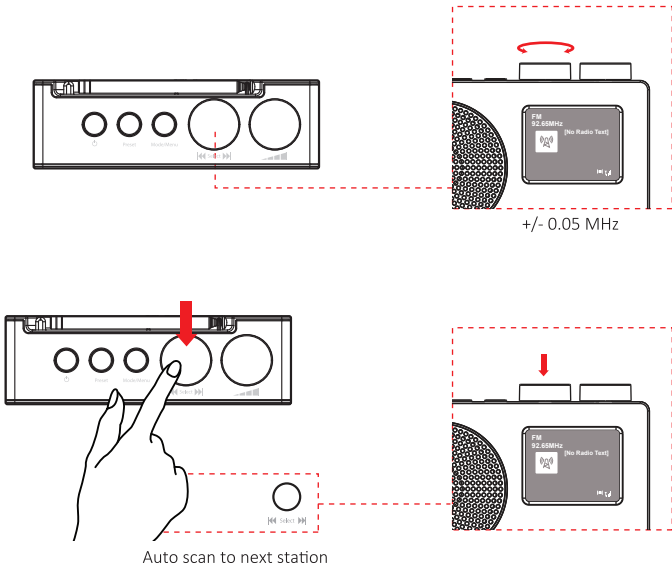

## 7. Menu

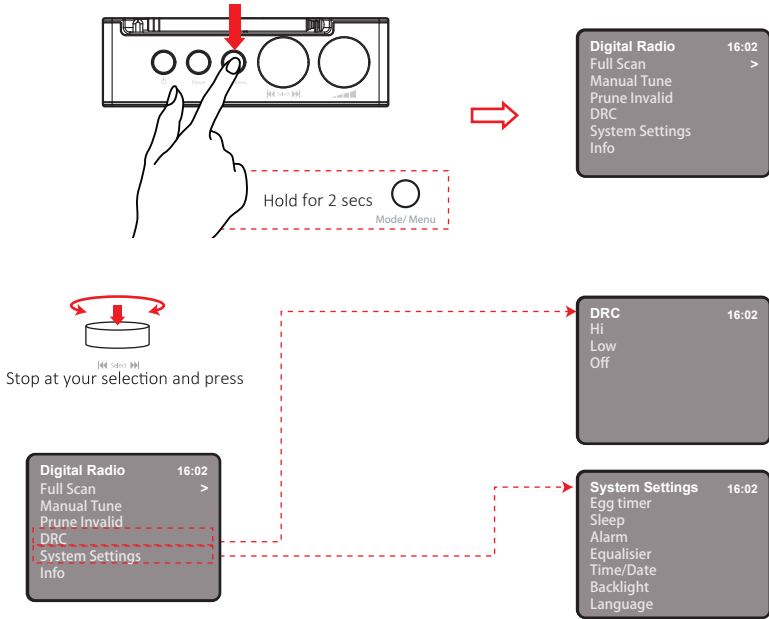

## 8. Slide Show

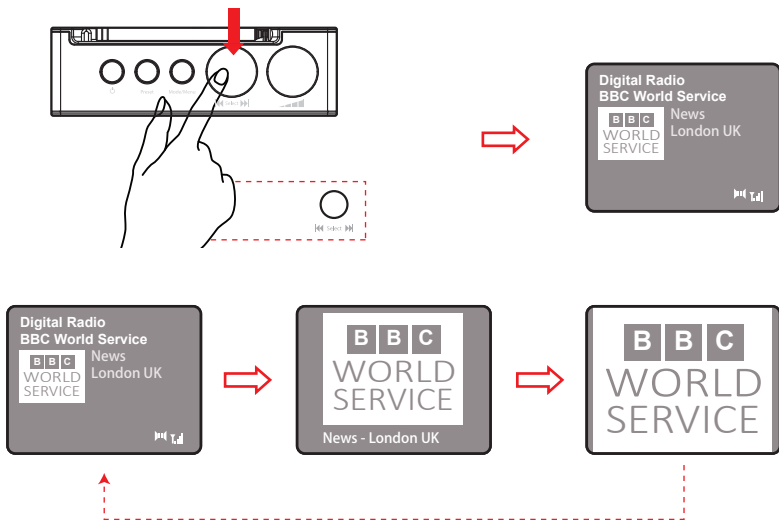

## 9. Timer

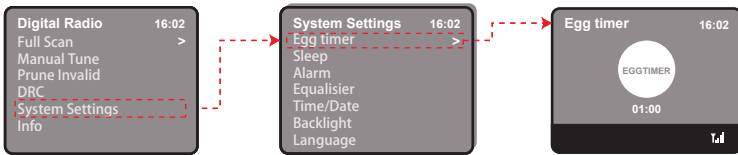
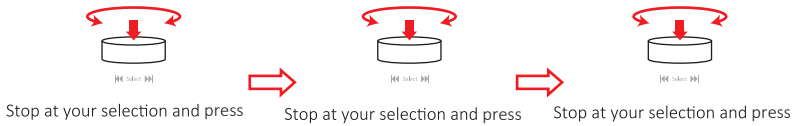
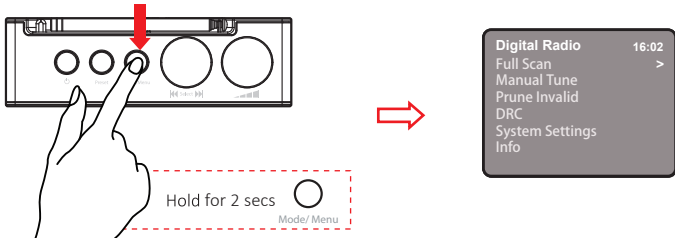

Select from 1 to 99 minutes; press POWER to stop the buzzer.

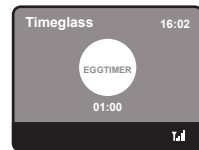

Note: After the alarm goes off, just wait for re-connection of the radio, it depends on the signal strength.

# 10. Sleep

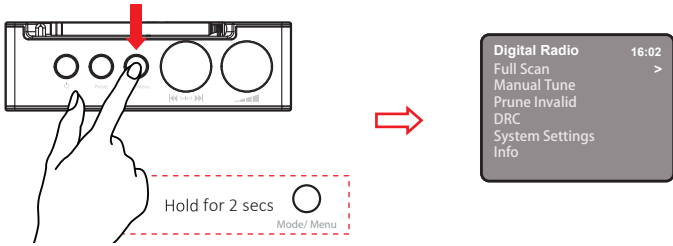

Stop at your selection and press      Stop at your selection and press

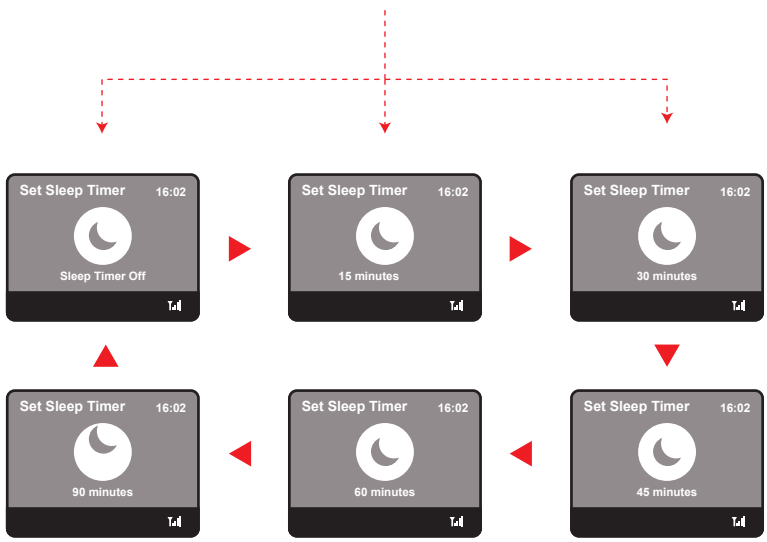
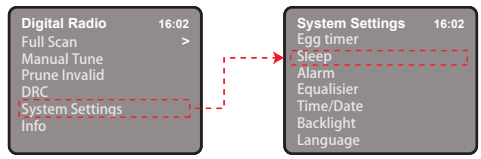

# 11. Alarm

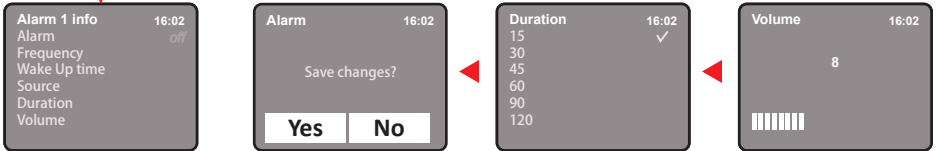
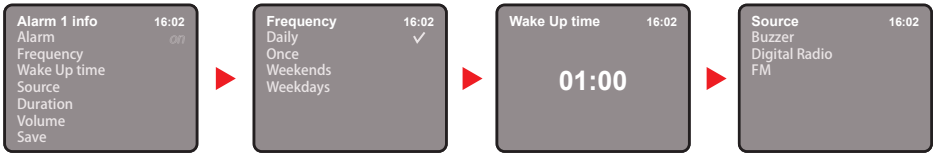
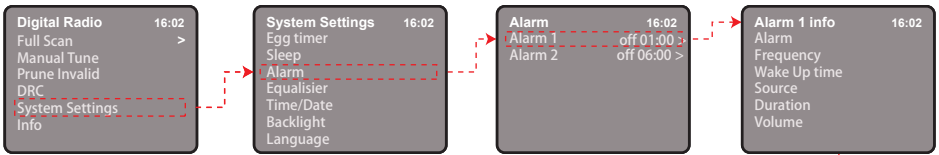
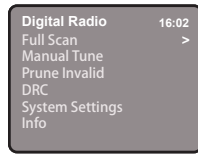
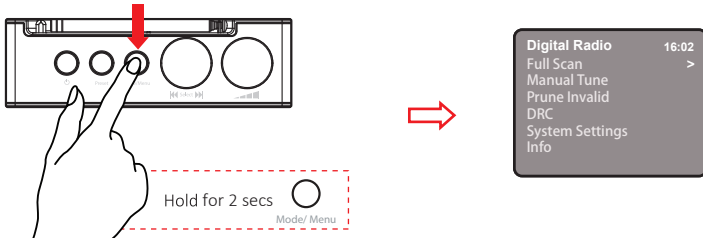



# 13. My EQ Setup

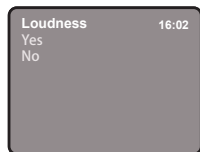
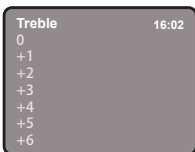
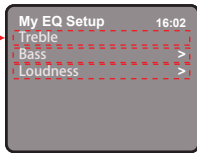
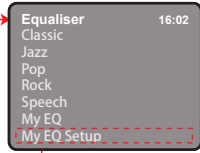
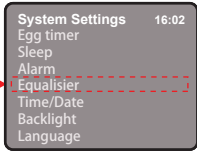
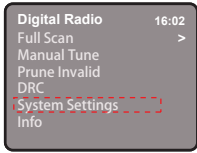
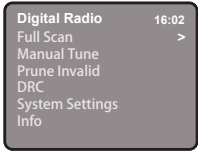
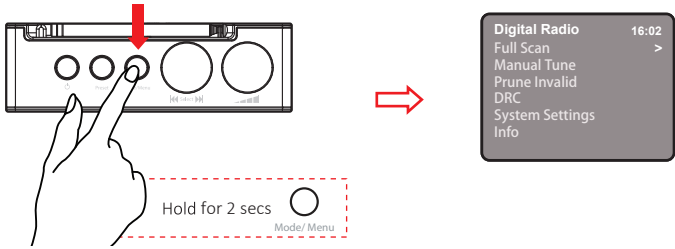

# 14. Time/Date

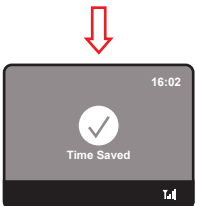
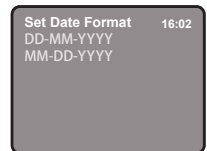
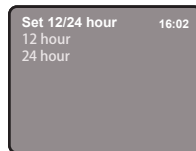
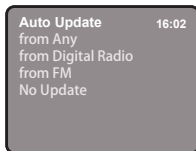
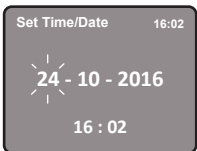
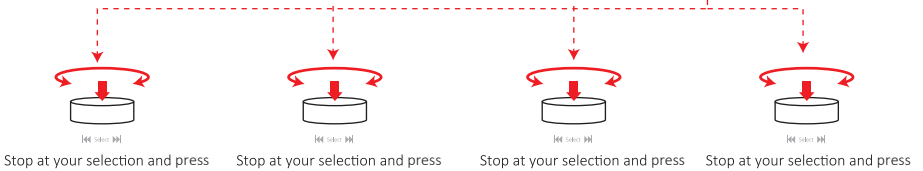
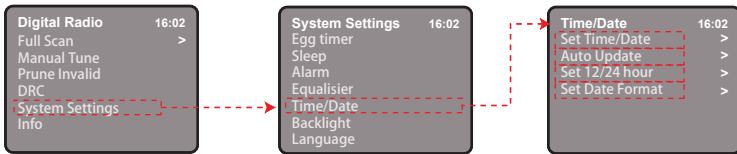
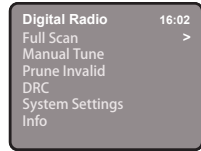
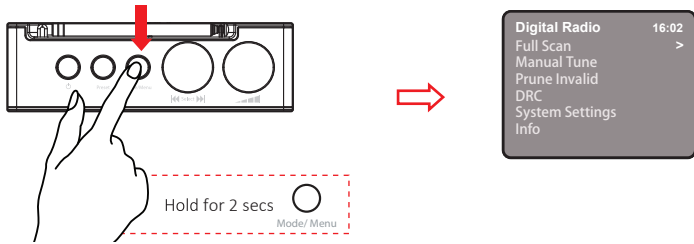



# 15. Backlight

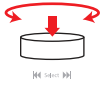
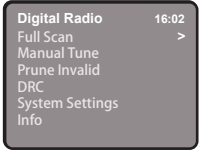
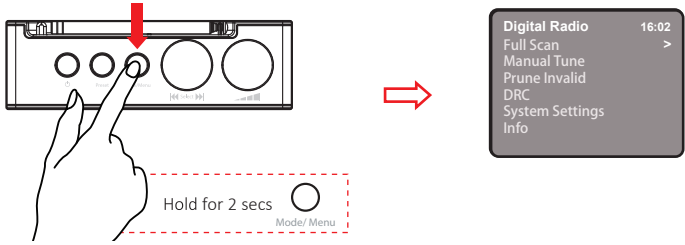

Stop at your selection and press

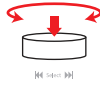

Stop at your selection and press



Stop at your selection and press

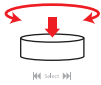
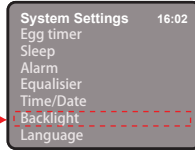
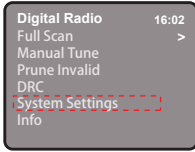

Stop at your selection and press

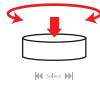

Stop at your selection and press



Stop at your selection and press

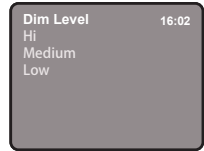

⋮



## 16. Language

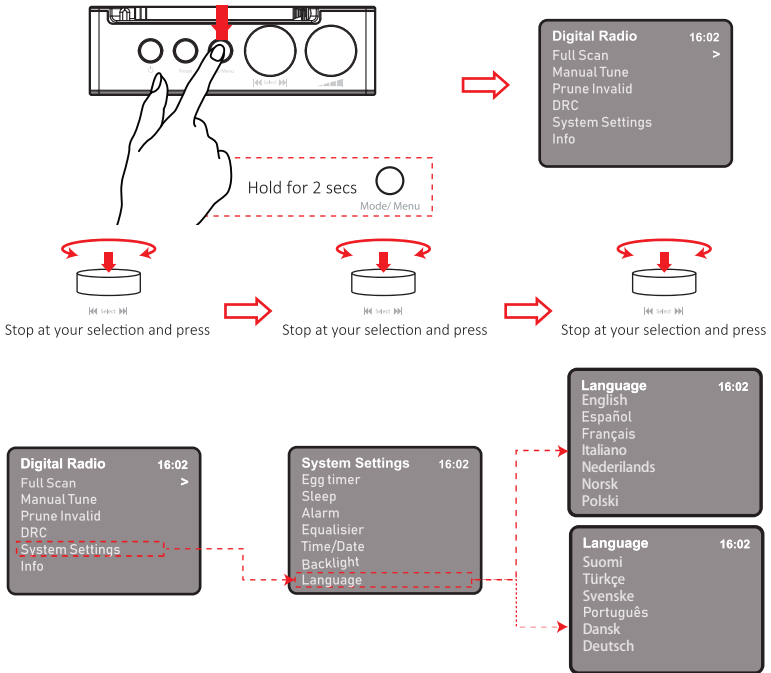

## 17. Factory Reset

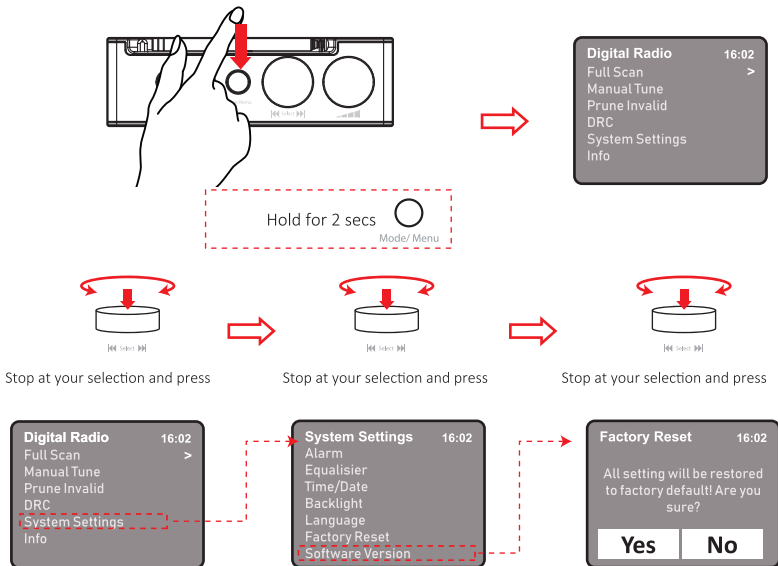

Note: Factory reset will erase all station lists, settings previously stored

## 18. Store Stations

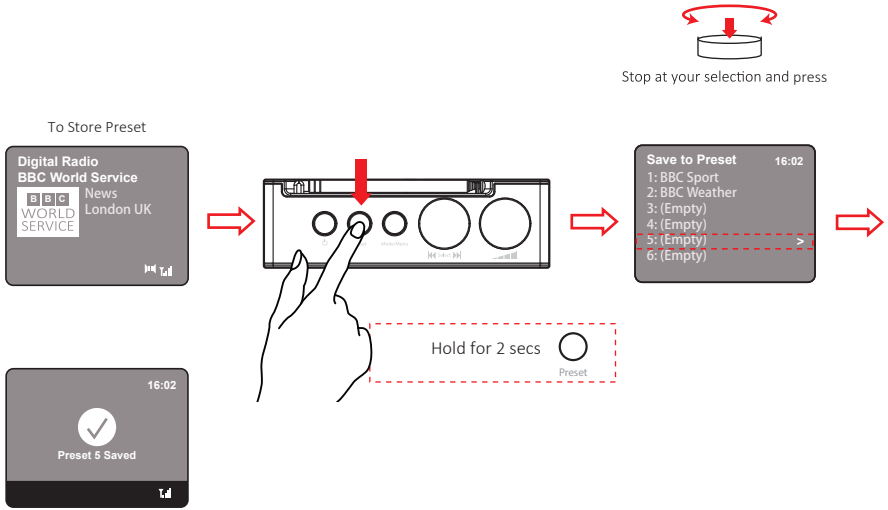

## 19. Recall Store Stations

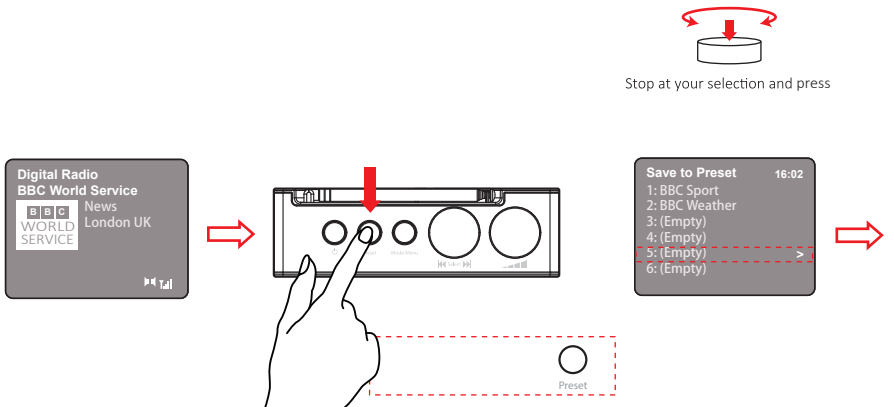

# Trouble Shooting

Problem: FM Hiss/DAB Burbling/intermittent cut-out/DAB No stations available message

Cause: Low signal strength

Solution: Check/move antenna. Move radio. Rescan local (high-strength) stations only. (For DAB, check local coverage at [www.ukdigitalradio.com/coverage](http://www.ukdigitalradio.com/coverage) then rescan stations).

## Error messages

'Service not available': No DAB reception.

'Signal error': The DAB signal has been interrupted.

'No DAB Station': The listed station cannot be found. (No Name):  
The current station does not broadcast an identity name.

'No stations found': No DAB stations are available, check aerial.

'No RadioText': No RDS text information is available on this station.

'No PTY': No RDS programme type information is available.

'No Name': No RDS station name is being broadcast.

## Specifications

Description: DAB+/FM Digital Radio

Speaker: 1 x 1W rms

Frequency Ranges: FM: 87.5-108MHz; DAB/DAB+: 174-240MHz

LCD Display: 2.4 inches colour TFT display

Power Supply: DC power input: 4 x 1.5V AA-size batteries (Not included)  
Power adapter: DC 5.0V 1.0A  
(please use our provided adapter)

Dimensions: 155mm x 107mm x 48mm

## General Information

### Care and Maintenance

Your radio is of superior design and manufacture and should be treated with care. The suggestions below will help you to enjoy this product and the benefits it brings for many years.

- Keep the product and all its parts out of reach of small children.
- Keep it dry. Avoid exposure to precipitation, humidity and liquids which could all affect the product circuitry.
- Do not leave it in high temperatures as electronic devices and plastic parts may warp in heat.
- Do not leave it in low temperatures as moisture can form inside the product, which may damage the circuit board.
- Do not store in dusty or dirty areas.
- Do not use harsh chemicals, cleaning solvents or detergents to clean the product. Wipe with a damp (not wet) soft cloth to clean.
- Do not attempt to open the product. Unauthorised handling of the device may damage it and will void your warranty.
- Only use the power supply that came with the product. Using an unauthorised power supply will invalidate your guarantee and may irreversibly damage the radio.

### Guarantee

This product is guaranteed for 1 year from the date of original purchase against mechanical and electrical defects. You will get extra 2 years warranty period by registered your product within 30 days after purchase. Please fill in required information on the warranty card and email back to [cs@smith-style.com](mailto:cs@smith-style.com) within 30 days of purchase.

Any defect that arises due to faulty materials or workmanship will either be replaced, refunded or repaired free of charge where possible during this period by the dealer from whom you purchased the unit.

The guarantee is subject to the following provisions:

- The guarantee does not cover accidental damage, misuse, cabinet parts, knobs or consumable items.
- The product must be correctly installed and operated in accordance with the instructions contained in this manual.
- It must be solely for domestic purpose.
- The guarantee will be rendered invalid if the product is re-sold or has been damaged by inexpert repair.
- Specifications are subject to change without notice.

The manufacturer disclaims any liability for the incidental or consequential damages.

- The guarantee is in addition to and does not diminish your statutory or legal rights.

Guarantor: Smith Style Consumer Products Company Ltd.

Unit 5 KBF House

55 Vitoria Road, Burgess Hill

West Sussex

RH15 9LH



This symbol indicates that this product should not be treated as normal household waste and it should be recycled. Please take it to your nearest collection facility or for further details contact your local council or visit [www.recycle-more.co.uk](http://www.recycle-more.co.uk)



Batteries contain substances that may be harmful to the environment and human health. Keep out of the reach of children and seek immediate medical help if swallowed.

This symbol indicates that batteries should not be disposed of in the normal household waste but taken to appropriate local recycling facilities, where and when these are available.

Never throw batteries in a fire or attempt to open the outer casing.









此页不印刷

## DB448-2说明书 (Smith)

# V6

202.12.8

材质：80G书纸，尺寸：135\*210MM  
单黑印刷：20P, 订装

WBS: TP00126.1.9/TP00127.1.9/TP00128.1.9

ID: TF-001010

V3:语言选择增加为13国语言。

V4: 改Smith-Style

V5: 删除封面POP.

V6: 更改封底:

Smith Style Consumer Products Company Ltd.